

CIMA ALLE COSTE  
 VIA DELLA CLESSIDRA  
 GIORDANI M. e MAURINI R.  
 1985  
 SVIL.: 500  
 DIFF.: V+, VI+, VII

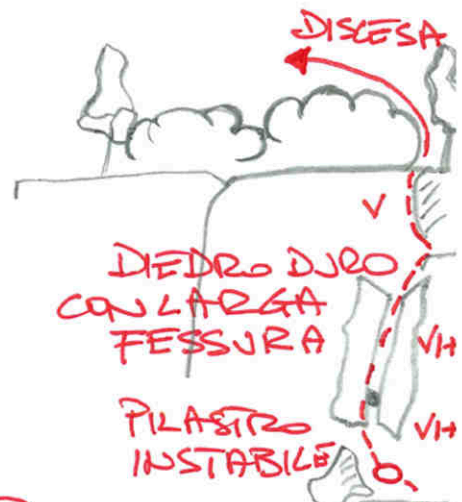

VIA LA LUNA E IL FALÒ



DIEDRO MARTINI

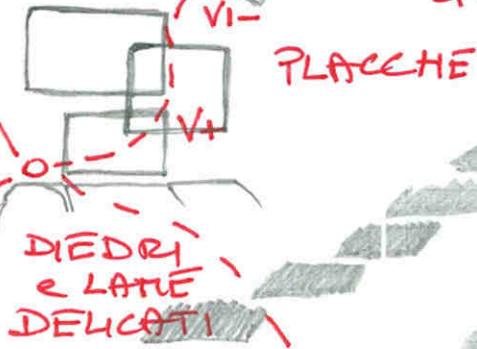

TRAVERSO  
 ERBOSO e  
 DELICATO



FINO ALLA CENGLIA MEDIANA  
 LUNGO IL DIEDRO STEINKÖTER/MESNER